



City of Hurricane Deck Requirements Form

To expedite the review and issuance of the building permit application for decks, please complete the following form. A permit cannot be issued for a deck until the following information has been completed and approved by the Building Code Officer.

1. What is the size of your deck? _____ (length) _____ (width) _____ (height)
2. What type of material is the deck constructed of? _____
(Decay resistance wood is required in all deck construction.)
3. What is the height of the deck floor above the grade of the yard? _____" (inches)
4. What is the thickness of the deck floor? _____" (inches)
5. What is the size and spacing of the floor joists? _____" x _____" spaced _____" (on center)
6. What is the depth, size and spacing of posts? _____" x _____", post _____ deep, and spaced _____" apart. (Minimum 30" below grade).
7. What is the size of post footings? _____" diameter (Concrete 8" minimum diameter.)
8. What are the size and spans of header beams? _____" x _____" x _____' long.
9. Is the deck attached to the house? Yes _____ No _____ If yes, what type of flashing is used?

10. What is the height of the guardrail? _____" (Guardrail is required if deck is 18" or more above grade, minimum 34" high and not more than 38" high.)
11. Guardrail intermediate enclosures must be vertical. What is the spacing of guardrail intermediate enclosures? _____" (Maximum clear opening between enclosures is 4.)
12. What is the height of the stair riser? _____" (maximum 7")
13. What is the depth of the stair tread? _____" (minimum 11")
14. Is a stair handrail provided? Yes _____ No _____ (Handrail required for 4 or more stairs.)
15. What is the spacing of hand rail intermediate enclosures? _____" (Maximum clear opening between enclosures is 4" {R-315.4}.)

Contractor or Homeowner Signature

Date

Upon Approval

Code Official Signature

Date

Basic Elements of a Typical Deck

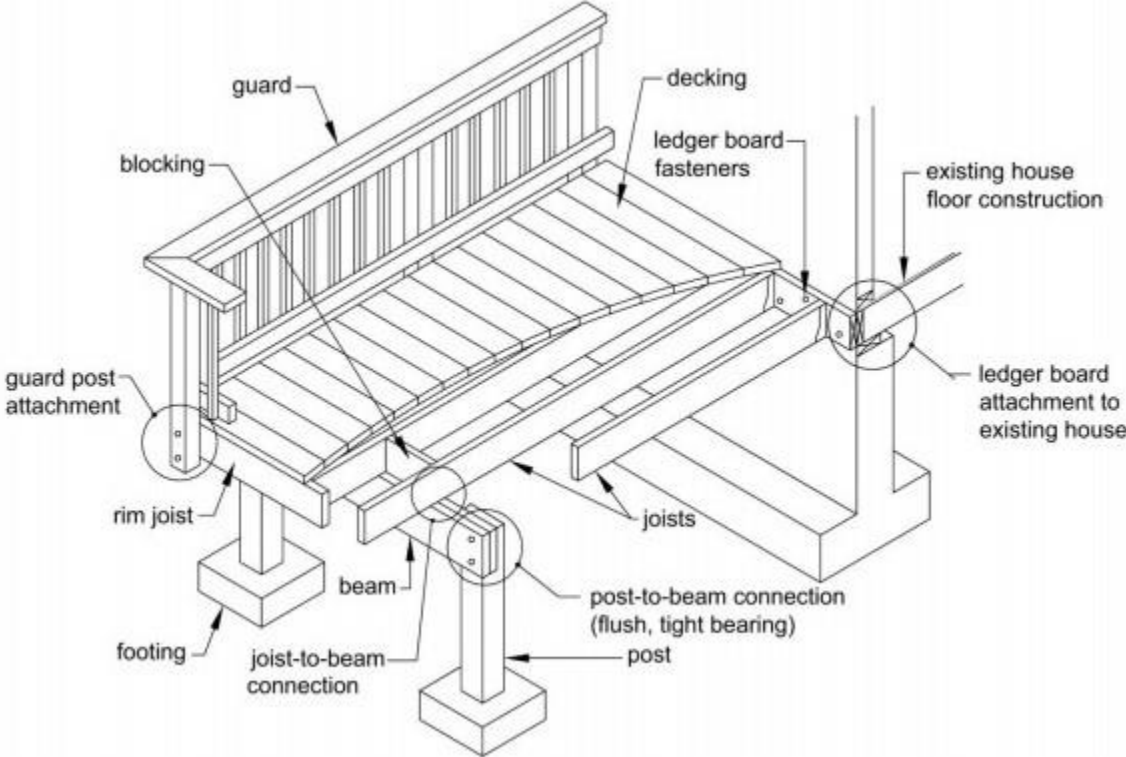

Placement of Lag Screws and Bolts in Ledgers

FIGURE R507.2.1(1)
PLACEMENT OF LAG SCREWS AND BOLTS IN LEDGERS

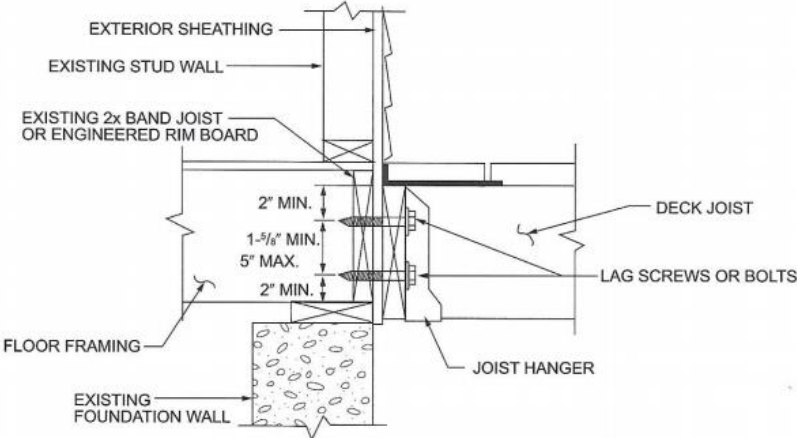

For SI: 1 inch = 25.4 mm.

DECK & BALCONY REQUIREMENTS

- MINIMUM FOOTER DEPTH FOR JURISDICTION IS 30" DEEP
- CONCRETE AROUND FOOTER POST MINIMUM 8" DIAMETER
- IF WOOD COLUMN OR POST IS OVER 4' HIGH, USE MINIMUM 6X6
- DECKS SHALL BE CONSTRUCTED TO CARRY A MINIMUM 40 PSF LIVE LOAD PER R301.5
- EXTERIOR BALCONIES SHALL BE CONSTRUCTED TO CARRY A MINIMUM 60PSF LIVE LOAD PER R301.5
- DECKS SHALL BE POSITIVELY ANCHORED TO THE PRIMARY STRUCTURE. THE USE OF NAILS OR TOENAILS SUBJECT TO WITHDRAWAL IS NOT ALLOWED PER R502.2.1
- ALL OF THE PROPER SIZE SHALL BE USED FOR USE OF THRU BOLTS, WASHERS, NUTS AND LAG BOLTS
- EXTERIOR OPEN DECK AND BALCONY MATERIAL: PRESSURE PRESERVATIVE TREATED WOOD PER R 319
- FASTENERS FOR PRESSURE PRESERVATIVE AND FIRE-RETARDANT-TREATED WOOD SHALL BE OF HOT-DIPPED GALVANIZED STEEL, STAINLESS STEEL, SILICON BRONZE OR COPPER. EXCEPTION: ½" OR GREATER STEEL BOLTS ALLOWED PER R319.3
- JOIST HANGERS MUST BE GALVANIZED AND HAVE THE REQUIRED AMOUNT OF FASTENERS INSTALLED (ALL HOLES MUST BE USED)
- DECK HEIGHT ABOVE GRADE OR ANOTHER FLOOR OF 30" OR MORE SHALL HAVE GUARDS NOT LESS THAN 36" HIGH PER R312
- STAIRS WITH A TOTAL RISE OF MORE THAN 30" ABOVE GRADE SHALL HAVE GUARDS MINIMUM 34" HIGH ABOVE THREAD NOSING PER R312
- STAIRS WITH A TOTAL RISE OF MORE THAN 30" ABOVE GRADE SHALL HAVE GUARDS MINIMUM 34" HIGH ABOVE THREAD NOSING PER R312
- THE INTERMEDIATE RAIL OR SPINDLES ON GUARDS SHALL NOT ALLOW THE PASSAGE OF A 4" SPHERE
- STAIRS 11" MINIMUM THREAD, 7" MAXIMUM RISERS PER STATE AMENDMENT
- GUARDRAILS AND HANDRAILS SHALL CARRY A MINIMUM 200 POUNDS CONCENTRATED LOAD APPLIED IN ANY DIRECTION AT ANY POINT ALONG THE TOP PER R301.5
- SEE INTERNATIONAL RESIDENTIAL CODE SECTIONS R301, R312, R319, R502, WV STATE AMENDMENTS FOR STAIR GEOMETRY AND LOCAL JURISDICTION REQUIREMENTS FOR FROST DEPTH